

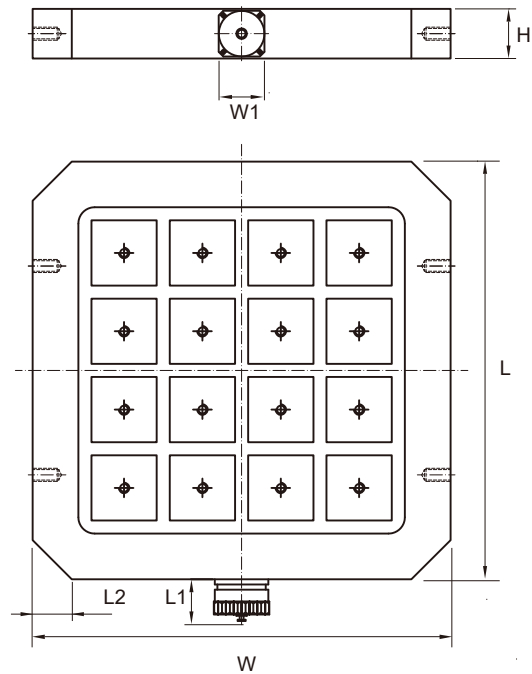

• Square pole electro-permanent pallet chuck

Use:
Clamping for heavy machining for medium to large work pieces

- Features:**
- Square pole size 50x50 mm
 - Magnetic force higher than 350 kg per pole
 - Electro-permanent technology with no deformation owing to the rise of temperature
 - Distortion free clamping with auto-shim pole extensions
 - No residual magnetism
 - Controlled flux prevents magnetization of the tool
 - Workpiece larger than the table size are machinable



Model	Width(W)	Length(L)	Height(H)	W1	L1	L2	Controller (220/400V)	Net Weight
PPN 3232	320 (12.60)	320 (12.60)	38 (1.50)	35 (1.38)	35 (1.38)	30 (1.18) x 45°	CUA	30 kg / 66 lb

Unit: mm(in)



• Permanent magnetic pallet chuck

Use:
For zero point clamping systems

- Features:**
- Aluminium housing
 - Pole pitch 5+3 mm
 - Two switchable sections
 - Max magnetic clamping force up to 160 N/cm²
 - Low magnetic flux

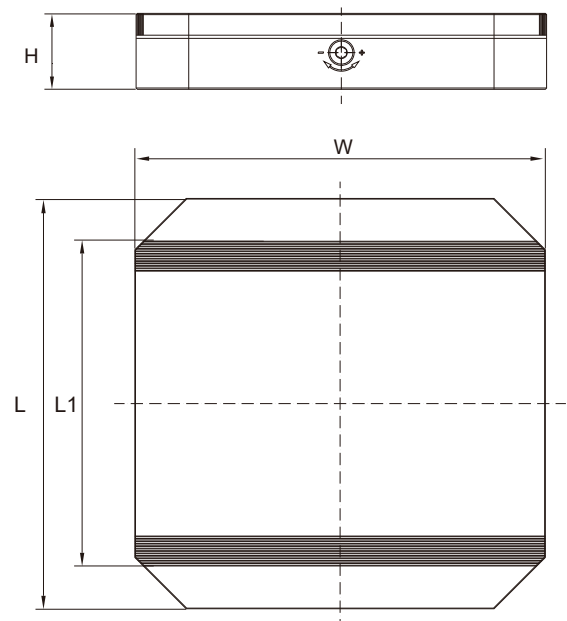

Model	Width(W)	Length(L)	Height(H)	L1	Net Weight
PPA 2424	240 (9.45)	240 (9.45)	60 (2.36)	174 (6.85)	19.5 kg / 43 lb
PPA 2828	280 (11.02)	280 (11.02)	60 (2.36)	214 (8.43)	22 kg / 49 lb
PPA 3232	320 (12.60)	320 (12.60)	60 (2.36)	254 (10)	26 kg / 57 lb

Unit: mm(in)